

# Koło zębate GT 3MR

Podziałka 3 mm

Materiał

Aluminium

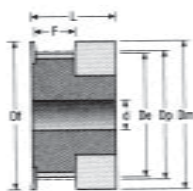

wykonanie 1F

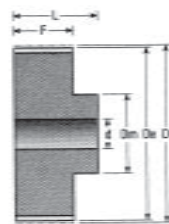

wykonanie 6F

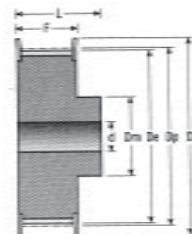

wykonanie 6

## dla pasa o szerokości 9 mm

Kod	Oznaczenie	Ilość zębów z	Wyko- nanie	Wymiar Ø Dp	Ø De	Wymiar koła Ø Df	F	L	Dm	Technol. otwór Ø d	⚙️ kg
T 76732	10 -3MR -09	10	1F	9.55	8.79	13.0	10.2	17.5	13.0	-	0.004
T 76733	12 -3MR -09	12	1F	11.46	10.70	15.0	10.2	17.5	15.0	-	0.006
T 76734	14 -3MR -09	14	1F	13.37	12.61	16.0	10.2	17.5	16.0	-	0.007
T 76735	15 -3MR -09	15	1F	14.32	13.56	17.5	10.2	17.5	17.5	-	0.008
T 76736	16 -3MR -09	16	6F	15.28	14.52	18.0	12.8	20.6	9.5	4	0.007
T 76737	18 -3MR -09	18	6F	17.19	16.43	19.5	12.8	20.6	10.0	6	0.008
T 76738	20 -3MR -09	20	6F	19.10	18.34	23.0	12.8	20.6	12.0	6	0.010
T 76739	21 -3MR -09	21	6F	20.05	19.29	25.0	12.8	20.6	13.0	6	0.013
T 76740	22 -3MR -09	22	6F	21.01	20.25	25.0	12.8	20.6	13.0	6	0.014
T 76741	24 -3MR -09	24	6F	22.92	22.16	25.0	12.8	20.6	13.0	6	0.016
T 76742	26 -3MR -09	26	6F	24.83	24.07	28.0	12.8	20.6	16.0	6	0.018
T 76743	28 -3MR -09	28	6F	26.74	25.98	32.0	12.8	20.6	18.0	6	0.024
T 76744	30 -3MR -09	30	6F	28.65	27.89	32.0	12.8	20.6	19.0	6	0.028
T 76745	32 -3MR -09	32	6F	30.56	29.80	36.0	12.8	20.6	22.0	6	0.032
T 76746	36 -3MR -09	36	6F	34.38	33.62	38.0	13.4	22.2	26.0	6	0.045
T 76747	40 -3MR -09	40	6F	38.20	37.44	42.0	13.4	22.2	28.0	6	0.055
T 76748	44 -3MR -09	44	6F	42.02	41.26	48.0	13.4	22.2	33.0	6	0.074
T 76749	48 -3MR -09	48	6	45.84	45.08	-	13.4	22.2	33.0	8	0.074
T 76750	60 -3MR -09	60	6	57.30	56.54	-	13.4	22.2	33.0	8	0.106
T 76751	72 -3MR -09	72	6	68.75	67.99	-	13.4	22.2	33.0	8	0.145

## dla pasa o szerokości 15 mm

T 76752	10 -3MR -15	10	1F	9.55	8.79	13.0	17.0	26.0	13.0	-	0.006
T 76753	12 -3MR -15	12	1F	11.46	10.70	15.0	17.0	26.0	15.0	-	0.008
T 76754	14 -3MR -15	14	1F	13.37	12.61	16.0	17.0	26.0	16.0	-	0.010
T 76755	15 -3MR -15	15	1F	14.32	13.56	17.5	17.0	26.0	17.5	-	0.012
T 76756	16 -3MR -15	16	6F	15.28	14.52	18.0	19.5	26.0	9.5	4	0.010
T 76757	18 -3MR -15	18	6F	17.19	16.43	19.5	19.5	26.0	10.0	6	0.012
T 76758	20 -3MR -15	20	6F	19.10	18.34	23.0	19.5	26.0	12.0	6	0.014
T 76759	21 -3MR -15	21	6F	20.05	19.29	25.0	19.5	26.0	13.0	6	0.016
T 76760	22 -3MR -15	22	6F	21.01	20.25	25.0	19.5	26.0	13.0	6	0.018
T 76761	24 -3MR -15	24	6F	22.92	22.16	25.0	19.5	26.0	13.0	6	0.020
T 76762	26 -3MR -15	26	6F	24.83	24.07	28.0	19.5	26.0	16.0	6	0.027
T 76763	28 -3MR -15	28	6F	26.74	25.98	32.0	19.5	26.0	18.0	6	0.030
T 76764	30 -3MR -15	30	6F	28.65	27.89	32.0	19.5	26.0	20.0	6	0.035
T 76765	32 -3MR -15	32	6F	30.56	29.80	36.0	19.5	26.0	22.0	6	0.042
T 76766	36 -3MR -15	36	6F	34.38	33.62	38.0	20.0	30.0	26.0	6	0.060
T 76767	40 -3MR -15	40	6F	38.20	37.44	42.0	20.0	30.0	28.0	6	0.075
T 76768	44 -3MR -15	44	6F	42.02	41.26	48.0	20.0	30.0	33.0	6	0.100
T 76769	48 -3MR -15	48	6	45.84	45.08	-	20.0	30.0	33.0	8	0.103
T 76770	60 -3MR -15	60	6	57.30	56.54	-	20.0	30.0	33.0	8	0.150
T 76771	72 -3MR -15	72	6	68.75	67.99	-	20.0	30.0	33.0	8	0.212

Rozmiary w mm.

### UWAGA:

Pasy zębate 3MGT patrz strona G 95 - G 96.

# Koło zębate GT 5MR

Podziałka 5 mm

Materiał

patrz niżej

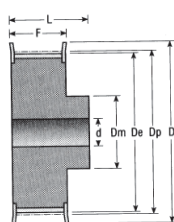

wykonanie 6F

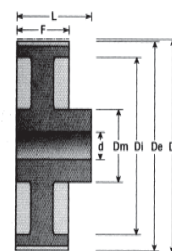

wykonanie 6W

## dla pasa o szerokości 9 mm

Kod	Oznaczenie	Ilość zębów z	Wykonanie	Materiał	Wymiar $\emptyset$ Dp	$\emptyset$ De	Wymiar koła $\emptyset$ Df	F	L	Dm	Technol. otwór $\emptyset$ d	$\emptyset$ kg
T 76772	12 -5MR -09	12	6F	St	19.10	17.96	23	14.5	20.0	12.5	4	0.028
T 76773	14 -5MR -09	14	6F	St	22.28	21.14	25	14.5	20.0	13.5	6	0.034
T 76774	15 -5MR -09	15	6F	St	23.87	22.73	28	14.5	20.0	15.5	6	0.042
T 76775	16 -5MR -09	16	6F	St	25.46	24.32	28	14.5	20.0	16.5	6	0.050
T 76776	18 -5MR -09	18	6F	St	28.65	27.51	32	14.5	20.0	20.0	6	0.070
T 76777	20 -5MR -09	20	6F	St	31.83	30.69	36	14.5	22.5	23.0	6	0.094
T 76778	21 -5MR -09	21	6F	St	33.42	32.28	38	14.5	22.5	24.0	6	0.110
T 76779	22 -5MR -09	22	6F	St	35.01	33.87	38	14.5	22.5	25.5	6	0.118
T 76780	24 -5MR -09	24	6F	St	38.20	37.06	42	14.5	22.5	27.0	6	0.145
T 76781	26 -5MR -09	26	6F	St	41.38	40.24	44	14.5	22.5	30.0	6	0.170
T 76782	28 -5MR -09	28	6F	St	44.56	43.42	48	14.5	22.5	30.5	6	0.200
T 76783	30 -5MR -09	30	6F	St	47.75	46.60	51	14.5	22.5	35.0	6	0.236
T 76784	32 -5MR -09	32	6F	St	50.93	49.79	54	14.5	22.5	38.0	8	0.270
T 76785	36 -5MR -09	36	6F	St	57.30	56.16	60	14.5	22.5	38.0	8	0.324
T 76786	40 -5MR -09	40	6F	St	63.66	62.52	71	14.5	22.5	38.0	8	0.400
T 76787	44 -5MR -09	44	6W	AL	70.03	68.89	-	14.5	25.5	38.0	8	0.170
T 76788	48 -5MR -09	48	6W	AL	76.39	75.25	-	14.5	25.5	45.0	8	0.182
T 76789	60 -5MR -09	60	6W	AL	95.49	94.35	-	14.5	25.5	45.0	8	0.230
T 76790	72 -5MR -09	72	6W	AL	114.59	113.45	-	14.5	25.5	45.0	8	0.270

## dla pasa o szerokości 15 mm

T 76791	12 -5MR -15	12	6F	St	19.10	17.96	23	20.5	26.0	13.0	4	0,034
T 76792	14 -5MR -15	14	6F	St	22.28	21.14	25	20.5	26.0	14.0	6	0.046
T 76793	15 -5MR -15	15	6F	St	23.87	22.73	28	20.5	26.0	16.0	6	0.056
T 76794	16 -5MR -15	16	6F	St	25.46	24.32	28	20.5	26.0	16.5	6	0.064
T 76795	18 -5MR -15	18	6F	St	28.65	27.51	32	20.5	26.0	20.0	6	0.086
T 76796	20 -5MR -15	20	6F	St	31.83	30.69	36	20.5	26.0	23.0	6	0.112
T 76797	21 -5MR -15	21	6F	St	33.42	32.28	38	20.5	26.0	24.0	6	0.130
T 76798	22 -5MR -15	22	6F	St	35.01	33.87	38	20.5	26.0	25.5	6	0.140
T 76799	24 -5MR -15	24	6F	St	38.20	37.06	42	20.5	28.0	27.0	6	0.180
T 76800	26 -5MR -15	26	6F	St	41.38	40.24	44	20.5	28.0	30.0	6	0.220
T 76801	28 -5MR -15	28	6F	St	44.56	43.42	48	20.5	28.0	30.5	6	0.250
T 76802	30 -5MR -15	30	6F	St	47.75	46.60	51	20.5	28.0	35.0	6	0.300
T 76803	32 -5MR -15	32	6F	St	50.93	49.79	54	20.5	28.0	38.0	8	0.350
T 76804	36 -5MR -15	36	6F	St	57.30	56.16	60	20.5	28.0	38.0	8	0.520
T 76805	40 -5MR -15	40	6F	St	63.66	62.52	71	20.5	28.0	38.0	8	0.426
T 76806	44 -5MR -15	44	6W	AL	70.03	68.89	-	20.5	30.0	38.0	8	0.225
T 76807	48 -5MR -15	48	6W	AL	76.39	75.25	-	20.5	30.0	38.0	8	0.187
T 76808	60 -5MR -15	60	6W	AL	95.49	94.35	-	20.5	30.0	50.0	8	0.305
T 76809	72 -5MR -15	72	6W	AL	114.59	113.45	-	20.5	30.0	50.0	8	0.375

Rozmiary w mm.

### UWAGA:

St = Stal

AL = Aluminium

Pasy zębate 5MGT patrz strona G 97 - G 98.

# Koło zębate GT 5MR

Podziałka 5 mm

Materiał

patrz niżej

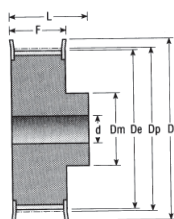

wykonanie 6F

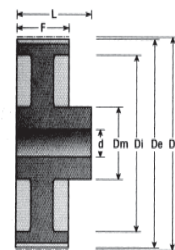

wykonanie 6W

## dla pasa o szerokości 25 mm

Kod	Oznaczenie	Ilość zębów z	Wyko-nanie	Mate-riół	Wymiar $\emptyset$ Dp	$\emptyset$ De	Wymiar koła $\emptyset$ Df	F	L	Dm	Technol. otwór $\emptyset$ d	$\frac{m}{kg}$
T 76810	12 -5MR -25	12	6F	St	19.10	17.96	23	30.5	36.0	13.0	4	0.050
T 76811	14 -5MR -25	14	6F	St	22.28	21.14	25	30.5	36.0	14.0	6	0.070
T 76812	15 -5MR -25	15	6F	St	23.87	22.73	28	30.5	36.0	16.0	6	0.080
T 76813	16 -5MR -25	16	6F	St	25.46	24.32	28	30.5	36.0	16.5	6	0.100
T 76814	18 -5MR -25	18	6F	St	28.65	27.51	32	30.5	36.0	20.0	6	0.120
T 76815	20 -5MR -25	20	6F	St	31.83	30.69	36	30.5	36.0	23.0	6	0.160
T 76816	21 -5MR -25	21	6F	St	33.42	32.28	38	30.5	38.0	24.0	6	0.190
T 76817	22 -5MR -25	22	6F	St	35.01	33.87	38	30.5	38.0	25.5	6	0.210
T 76818	24 -5MR -25	24	6F	St	38.20	37.06	42	30.5	38.0	27.0	6	0.250
T 76819	26 -5MR -25	26	6F	St	41.38	40.24	44	30.5	38.0	30.0	6	0.300
T 76820	28 -5MR -25	28	6F	St	44.56	43.42	48	30.5	38.0	30.5	6	0.350
T 76821	30 -5MR -25	30	6F	St	47.75	46.60	51	30.5	38.0	35.0	6	0.420
T 76822	32 -5MR -25	32	6F	St	50.93	49.79	54	30.5	38.0	38.0	8	0.480
T 76823	36 -5MR -25	36	6F	St	57.30	56.16	60	30.5	38.0	38.0	8	0.590
T 76824	40 -5MR -25	40	6F	St	63.66	62.52	71	30.5	38.0	38.0	8	0.740
T 76825	44 -5MR -25	44	6W	AL	70.03	68.89	-	30.5	40.0	38.0	8	0.320
T 76826	48 -5MR -25	48	6W	AL	76.39	75.25	-	30.5	40.0	38.0	8	0.275
T 76827	60 -5MR -25	60	6W	AL	95.49	94.35	-	30.5	40.0	50.0	8	0.435
T 76828	72 -5MR -25	72	6W	AL	114.59	113.45	-	30.5	40.0	50.0	8	0.525

Rozmiary w mm.

### UWAGA:

St = Stal

AL = Aluminium

Pasy zębate 5MGT patrz strona G 97-98.