

# KOŁA ZĘBATE O PODZIAŁCE CALOWEJ

ISO 5294

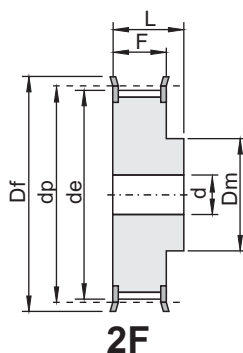

2F

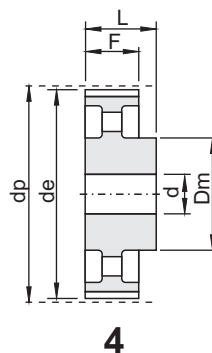

4

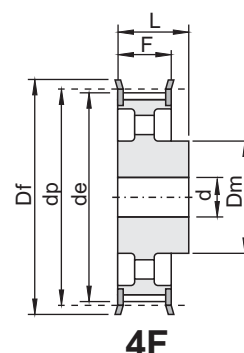

4F

**H 075**

podziałka: 1/2" (12,7 mm)

koła dla pasa o szerokości: 3/4" (19,05 mm)

kod	typ	rysunek	materiał	Z	dp	de	Df	Dm	F	L	d	nr flanszy	[kg]
M0160	14 H 075	2F	St	14	56,59	55,22	63	40	26,40	40	10	309	0,58
M0161	15 H 075	2F	St	15	60,64	59,27	66	45	26,40	40	10	310	0,69
M0162	16 H 075	2F	St	16	64,68	63,31	71	45	26,40	40	10	311	0,77
M0163	17 H 075	2F	St	17	68,72	67,35	75	45	26,40	40	12	312	0,84
M0164	18 H 075	2F	St	18	72,77	71,39	79	55	26,40	40	12	313	1,01
M0165	19 H 075	2F	St	19	76,81	75,44	83	60	26,40	40	12	314	1,15
M0166	20 H 075	2F	St	20	80,85	79,48	87	62	26,40	40	12	315	1,27
M0167	21 H 075	2F	St	21	84,89	83,52	91	65	26,40	40	12	316	1,41
M0168	22 H 075	2F	St	22	88,94	87,56	93	68	26,40	40	12	317	1,55
M0169	23 H 075	2F	St	23	92,98	91,61	97	72	26,40	40	12	318	1,71
M0170	24 H 075	2F	St	24	97,03	95,65	103	72	26,40	40	12	320	1,83
M0171	25 H 075	2F	St	25	101,06	99,69	106	72	26,40	40	12	321	1,96
M0172	26 H 075	2F	St	26	105,11	103,73	111	80	26,40	40	12	322	2,19
M0173	27 H 075	2F	St	27	109,15	107,78	115	80	26,40	40	12	323	2,32
M0174	28 H 075	2F	St	28	113,19	111,82	119	80	26,40	40	12	325	2,47
M0175	30 H 075	2F	St	30	121,29	119,90	127	80	26,40	40	14	327	2,76
M0176	32 H 075	2F	St	32	129,36	127,99	135	80	26,40	40	14	328	3,08
M0177	33 H 075	2F	St	33	133,40	132,03	140	80	26,40	40	14	330	3,25
M0178	34 H 075	2F	St	34	137,45	136,07	143	80	26,40	40	14	331	3,42
M0179	35 H 075	2F	St	35	141,49	140,12	148	80	26,40	40	14	333	3,61
M0180	36 H 075	2F	St	36	145,53	144,16	152	80	26,40	40	14	334	3,79
M0181	38 H 075	2F	St	38	153,62	152,24	158	80	26,40	40	14	335	4,16
M0182	40 H 075	2F	St	40	161,70	160,33	168	80	26,40	40	14	338	4,58
M0183	44 H 075	4F	GG	44	177,87	176,50	184	80	26,40	40	18	339	2,57
M0184	48 H 075	4F	GG	48	194,04	192,67	200	90	26,40	45	18	342	3,56
M0185	50 H 075	4	GG	50	202,13	200,75	-	90	26,40	45	18	-	3,74

# KOŁA ZĘBATE O PODZIAŁCE CALOWEJ

ISO 5294

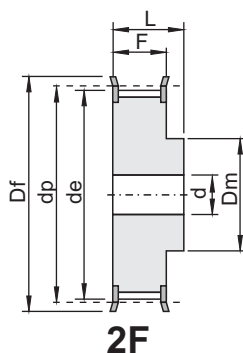

2F

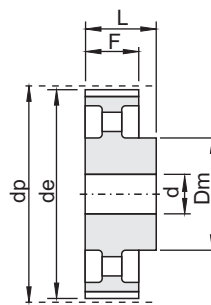

4

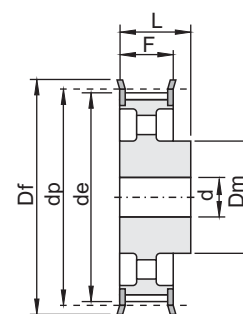

4F

**H 100**

podziałka: 1/2" (12,7 mm)

koła dla pasa o szerokości: 1" (25,4 mm)

kod	typ	rysunek	materiał	Z	dp	de	Df	Dm	F	L	d	nr flanszy	[kg]
M0186	14 H 100	2F	St	14	56,59	55,22	63	40	31,80	45	12	309	0,65
M0187	15 H 100	2F	St	15	60,64	59,27	66	45	31,80	45	12	310	0,77
M0188	16 H 100	2F	St	16	64,68	63,31	71	45	31,80	45	12	311	0,87
M0189	17 H 100	2F	St	17	68,72	67,35	75	45	31,80	45	12	312	0,97
M0190	18 H 100	2F	St	18	72,77	71,39	79	55	31,80	45	12	313	1,16
M0191	19 H 100	2F	St	19	76,81	75,44	83	60	31,80	45	14	314	1,30
M0192	20 H 100	2F	St	20	80,85	79,48	87	62	31,80	45	14	315	1,44
M0193	21 H 100	2F	St	21	84,89	83,52	91	65	31,80	45	14	316	1,60
M0194	22 H 100	2F	St	22	88,94	87,56	93	68	31,80	45	14	317	1,76
M0195	23 H 100	2F	St	23	92,98	91,61	97	72	31,80	45	14	318	1,94
M0196	24 H 100	2F	St	24	97,03	95,65	103	72	31,80	45	14	320	2,09
M0197	25 H 100	2F	St	25	101,06	99,69	106	72	31,80	45	14	321	2,24
M0198	26 H 100	2F	St	26	105,11	103,73	111	80	31,80	45	14	322	2,49
M0199	27 H 100	2F	St	27	109,15	107,78	115	80	31,80	45	14	323	2,66
M0200	28 H 100	2F	St	28	113,19	111,82	119	80	31,80	45	14	325	2,83
M0201	29 H 100	2F	St	29	117,23	115,86	123	80	31,80	45	14	326	3,01
M0202	30 H 100	2F	St	30	121,29	119,90	127	80	31,80	45	14	327	3,19
M0203	32 H 100	2F	St	32	129,36	127,99	135	80	31,80	45	14	328	3,57
M0204	33 H 100	2F	St	33	133,40	132,03	140	80	31,80	45	14	330	3,79
M0205	34 H 100	2F	St	34	137,45	136,07	143	80	31,80	45	14	331	3,99
M0206	35 H 100	2F	St	35	141,49	140,12	148	80	31,80	45	14	333	4,20
M0207	36 H 100	2F	St	36	145,53	144,16	152	80	31,80	45	14	334	4,44
M0208	38 H 100	2F	St	38	153,62	152,24	158	80	31,80	45	14	335	4,90
M0209	40 H 100	2F	St	40	161,70	160,33	168	80	31,80	45	14	338	5,39
M0210	44 H 100	4F	GG	44	177,87	176,50	184	80	31,80	50	18	339	3,37
M0211	45 H 100	4F	GG	45	181,91	180,54	192	80	31,80	50	18	340	3,57
M0212	48 H 100	4F	GG	48	194,04	192,67	200	90	31,80	50	18	342	4,10
M0213	50 H 100	4	GG	50	202,13	200,75	-	90	31,80	50	18	-	4,24
M0214	52 H 100	4	GG	52	210,21	208,84	-	90	31,80	50	18	-	4,32
M0215	58 H 100	4	GG	58	234,47	233,09	-	90	31,80	50	18	-	4,61
M0216	60 H 100	4	GG	60	242,55	241,18	-	100	31,80	50	18	-	5,30
M0217	70 H 100	4	GG	70	282,98	281,61	-	100	31,80	55	18	-	6,13
M0218	72 H 100	4	GG	72	291,06	289,69	-	120	31,80	55	18	-	7,47
M0219	84 H 100	4	GG	84	339,57	338,20	-	120	31,80	55	18	-	8,52
M0220	96 H 100	4	GG	96	388,08	386,71	-	120	31,80	60	18	-	10,25
M0221	120 H 100	4	GG	120	485,10	483,73	-	120	31,80	60	18	-	13,09

# KOŁA ZĘBATE O PODZIAŁCE CALOWEJ

ISO 5294

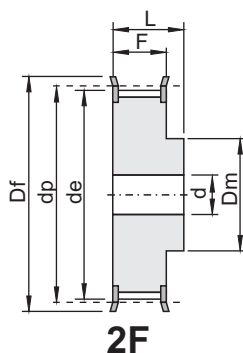

2F

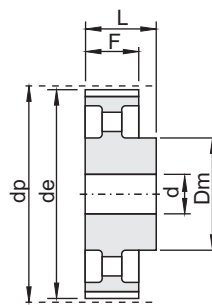

4

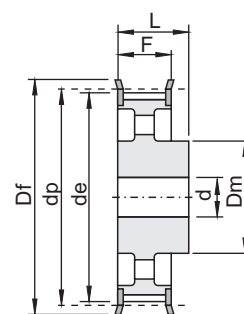

4F

**H 150**

podziałka: 1/2" (12,7 mm)

koła dla pasa o szerokości: 1"1/2 (38,1 mm)

kod	typ	rysunek	materiał	Z	dp	de	Df	Dm	F	L	d	nr flanszy	[kg]
M0222	14 H 150	2F	St	14	56,59	55,22	63	40	46,00	58	18	309	0,81
M0223	15 H 150	2F	St	15	60,64	59,27	66	45	46,00	58	18	310	0,97
M0224	16 H 150	2F	St	16	64,68	63,31	71	45	46,00	58	18	311	1,11
M0225	17 H 150	2F	St	17	68,72	67,35	75	45	46,00	58	18	312	1,25
M0226	18 H 150	2F	St	18	72,77	71,39	79	55	46,00	58	18	313	1,48
M0227	19 H 150	2F	St	19	76,81	75,44	83	60	46,00	58	18	314	1,68
M0228	20 H 150	2F	St	20	80,85	79,48	87	62	46,00	58	18	315	1,88
M0229	21 H 150	2F	St	21	84,89	83,52	91	65	46,00	58	18	316	2,08
M0230	22 H 150	2F	St	22	88,94	87,56	93	68	46,00	58	18	317	2,30
M0231	23 H 150	2F	St	23	92,98	91,61	97	72	46,00	58	18	318	2,54
M0232	24 H 150	2F	St	24	97,03	95,65	103	72	46,00	58	18	320	2,75
M0233	25 H 150	2F	St	25	101,06	99,69	106	72	46,00	58	18	321	2,97
M0234	26 H 150	2F	St	26	105,11	103,73	111	80	46,00	58	18	322	3,29
M0235	27 H 150	2F	St	27	109,15	107,78	115	80	46,00	58	18	323	3,52
M0236	28 H 150	2F	St	28	113,19	111,82	119	80	46,00	58	18	325	3,78
M0237	29 H 150	2F	St	29	117,23	115,86	123	80	46,00	58	18	326	4,03
M0238	30 H 150	2F	St	30	121,29	119,90	127	80	46,00	58	18	327	4,29
M0239	32 H 150	2F	St	32	129,36	127,99	135	80	46,00	58	18	328	4,86
M0240	33 H 150	2F	St	33	133,40	132,03	140	80	46,00	58	18	330	5,15
M0241	34 H 150	2F	St	34	137,45	136,07	143	80	46,00	58	18	331	5,46
M0242	35 H 150	2F	St	35	141,49	140,12	148	80	46,00	58	18	333	5,78
M0243	36 H 150	2F	St	36	145,53	144,16	152	80	46,00	58	18	334	6,09
M0244	38 H 150	2F	St	38	153,62	152,24	158	80	46,00	58	18	335	6,74
M0245	40 H 150	2F	St	40	161,70	160,33	168	80	46,00	58	18	338	7,46
M0246	44 H 150	4F	GG	44	177,87	176,50	184	80	46,00	58	18	339	4,29
M0247	45 H 150	4F	GG	45	181,91	180,54	192	80	46,00	58	18	340	4,44
M0248	48 H 150	4F	GG	48	194,04	192,67	200	90	46,00	65	18	342	5,41
M0249	50 H 150	4	GG	50	202,13	200,75	-	90	46,00	65	18	-	5,59
M0250	52 H 150	4	GG	52	210,21	208,84	-	90	46,00	65	18	-	5,79
M0251	58 H 150	4	GG	58	234,47	233,09	-	90	46,00	65	18	-	6,15
M0252	60 H 150	4	GG	60	242,55	241,18	-	100	46,00	65	18	-	7,08
M0253	70 H 150	4	GG	70	282,98	281,61	-	100	46,00	65	24	-	7,77
M0254	72 H 150	4	GG	72	291,06	289,69	-	120	46,00	65	24	-	9,70
M0255	84 H 150	4	GG	84	339,57	338,20	-	120	46,00	65	24	-	10,99
M0256	96 H 150	4	GG	96	388,08	386,71	-	120	46,00	65	24	-	12,24
M0257	120 H 150	4	GG	120	485,10	483,73	-	120	46,00	65	24	-	16,17

# KOŁA ZĘBATE O PODZIAŁCE CALOWEJ

ISO 5294

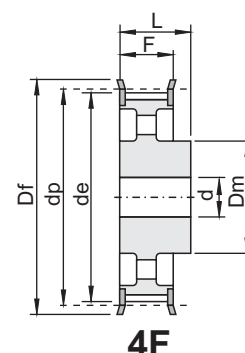
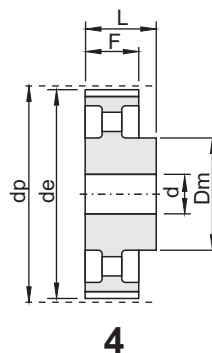
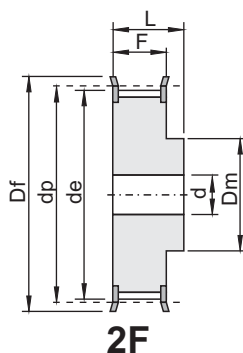

**H 200**

podziałka: 1/2" (12,7 mm)

koła dla pasa o szerokości: 2" (50,8 mm)

kod	typ	rysunek	materiał	Z	dp	de	Df	Dm	F	L	d	nr flanszy	[kg]
M0258	14 H 200	2F	St	14	56,59	55,22	63	40	58,70	70	18	309	1,10
M0259	15 H 200	2F	St	15	60,64	59,27	66	45	58,70	70	18	310	1,33
M0260	16 H 200	2F	St	16	64,68	63,31	71	45	58,70	70	18	311	1,54
M0261	17 H 200	2F	St	17	68,72	67,35	75	45	58,70	70	18	312	1,69
M0262	18 H 200	2F	St	18	72,77	71,39	79	55	58,70	70	18	313	1,95
M0263	19 H 200	2F	St	19	76,81	75,44	83	60	58,70	70	18	314	2,20
M0264	20 H 200	2F	St	20	80,85	79,48	87	62	58,70	70	18	315	2,44
M0265	21 H 200	2F	St	21	84,89	83,52	91	65	58,70	70	18	316	2,70
M0266	22 H 200	2F	St	22	88,94	87,56	93	68	58,70	70	18	317	2,97
M0267	23 H 200	2F	St	23	92,98	91,61	97	72	58,70	70	18	318	3,25
M0268	24 H 200	2F	St	24	97,03	95,65	103	72	58,70	70	18	320	3,56
M0269	25 H 200	2F	St	25	101,06	99,69	106	72	58,70	70	18	321	3,81
M0270	26 H 200	2F	St	26	105,11	103,73	111	80	58,70	70	18	322	4,18
M0271	27 H 200	2F	St	27	109,15	107,78	115	80	58,70	70	18	323	4,49
M0272	28 H 200	2F	St	28	113,19	111,82	119	80	58,70	70	18	325	4,81
M0273	29 H 200	2F	St	29	117,23	115,86	123	80	58,70	70	18	326	5,14
M0274	30 H 200	2F	St	30	121,29	119,90	127	80	58,70	70	18	327	5,47
M0275	32 H 200	2F	St	32	129,36	127,99	135	80	58,70	70	18	328	6,17
M0276	33 H 200	2F	St	33	133,40	132,03	140	80	58,70	70	18	330	6,56
M0277	34 H 200	2F	St	34	137,45	136,07	143	80	58,70	70	18	331	6,94
M0278	35 H 200	2F	St	35	141,49	140,12	148	80	58,70	70	18	333	7,34
M0279	36 H 200	2F	St	36	145,53	144,16	152	80	58,70	70	18	334	7,75
M0280	38 H 200	2F	St	38	153,62	152,24	158	80	58,70	70	18	335	8,62
M0281	40 H 200	2F	St	40	161,70	160,33	168	80	58,70	70	18	338	9,50
M0282	44 H 200	4F	GG	44	177,87	176,50	184	80	58,70	70	18	339	5,14
M0283	45 H 200	4F	GG	45	181,91	180,54	192	80	58,70	70	18	340	5,38
M0284	48 H 200	4F	GG	48	194,04	192,67	200	90	58,70	75	24	342	6,29
M0285	50 H 200	4	GG	50	202,13	200,75	-	90	58,70	75	24	-	6,68
M0286	52 H 200	4	GG	52	210,21	208,84	-	90	58,70	75	24	-	6,81
M0287	58 H 200	4	GG	58	234,47	233,09	-	90	58,70	75	24	-	7,26
M0288	60 H 200	4	GG	60	242,55	241,18	-	100	58,70	75	24	-	8,25
M0289	70 H 200	4	GG	70	282,98	281,61	-	100	58,70	75	28	-	9,20
M0290	72 H 200	4	GG	72	291,06	289,69	-	120	58,70	75	28	-	11,09
M0291	84 H 200	4	GG	84	339,57	338,20	-	120	58,70	75	28	-	12,63
M0292	96 H 200	4	GG	96	388,08	386,71	-	120	58,70	75	28	-	14,51
M0293	120 H 200	4	GG	120	485,10	483,73	-	120	58,70	75	28	-	19,15

# KOŁA ZĘBATE O PODZIAŁCE CALOWEJ

ISO 5294

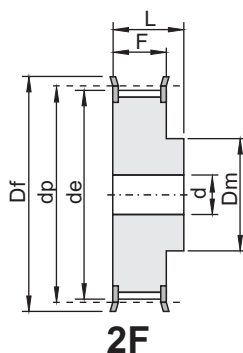

2F

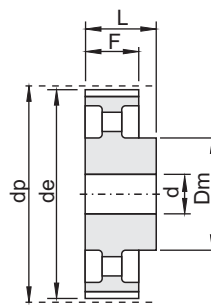

4

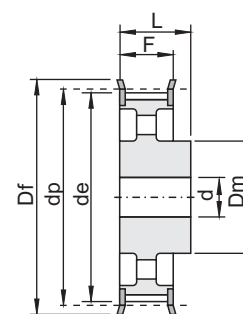

4F

**H 300**

podziałka: 1/2" (12,7 mm)

koła dla pasa o szerokości: 3" (76,2 mm)

kod	typ	rysunek	materiał	Z	dp	de	Df	Dm	F	L	d	nr flanszy	[kg]
M0294	14 H 300	2F	St	14	56,59	55,22	63	40	85,70	100	18	309	1,64
M0295	15 H 300	2F	St	15	60,64	59,27	66	45	85,70	100	18	310	1,91
M0296	16 H 300	2F	St	16	64,68	63,31	71	45	85,70	100	18	311	2,16
M0297	17 H 300	2F	St	17	68,72	67,35	75	45	85,70	100	18	312	2,43
M0298	18 H 300	2F	St	18	72,77	71,39	79	55	85,70	100	18	313	2,80
M0299	19 H 300	2F	St	19	76,81	75,44	83	60	85,70	100	18	314	3,16
M0300	20 H 300	2F	St	20	80,85	79,48	87	62	85,70	100	18	315	3,50
M0301	21 H 300	2F	St	21	84,89	83,52	91	65	85,70	100	18	316	3,87
M0302	22 H 300	2F	St	22	88,94	87,56	93	68	85,70	100	18	317	4,26
M0303	23 H 300	2F	St	23	92,98	91,61	97	72	85,70	100	18	318	4,68
M0304	24 H 300	2F	St	24	97,03	95,65	103	72	85,70	100	18	320	5,08
M0305	25 H 300	2F	St	25	101,06	99,69	106	72	85,70	100	18	321	5,45
M0306	26 H 300	2F	St	26	105,11	103,73	111	80	85,70	100	18	322	6,01
M0307	27 H 300	2F	St	27	109,15	107,78	115	80	85,70	100	18	323	6,45
M0308	28 H 300	2F	St	28	113,19	111,82	119	80	85,70	100	18	325	6,91
M0309	30 H 300	2F	St	30	121,29	119,90	127	80	85,70	100	18	327	7,90
M0310	32 H 300	2F	St	32	129,36	127,99	135	80	85,70	100	18	328	8,92
M0311	33 H 300	2F	St	33	133,40	132,03	140	80	85,70	100	18	330	9,46
M0312	34 H 300	2F	St	34	137,45	136,07	143	80	85,70	100	18	331	10,04
M0313	35 H 300	2F	St	35	141,49	140,12	148	80	85,70	100	18	333	10,62
M0314	36 H 300	2F	St	36	145,53	144,16	152	80	85,70	100	18	334	11,24
M0315	38 H 300	2F	St	38	153,62	152,24	158	80	85,70	100	18	335	12,44
M0316	40 H 300	2F	St	40	161,70	160,33	168	80	85,70	100	18	338	13,80
M0317	44 H 300	4F	GG	44	177,87	176,50	184	80	85,70	100	24	339	7,22
M0318	48 H 300	4F	GG	48	194,04	192,67	200	90	85,70	100	24	342	8,60
M0319	50 H 300	4	GG	50	202,13	200,75	-	90	85,70	100	24	-	8,99
M0320	58 H 300	4	GG	58	234,47	233,09	-	90	85,70	100	24	-	10,04
M0321	60 H 300	4	GG	60	242,55	241,18	-	100	85,70	100	24	-	11,18
M0322	72 H 300	4	GG	72	291,06	289,69	-	120	85,70	100	28	-	15,07
M0323	84 H 300	4	GG	84	339,57	338,20	-	120	85,70	100	28	-	16,97
M0324	96 H 300	4	GG	96	388,08	386,71	-	120	85,70	100	28	-	19,86
M0325	120 H 300	4	GG	120	485,10	483,73	-	120	85,70	100	28	-	25,91