

WAŁKI ZĘBATE O PODZIAŁCE CALOWEJ

ISO 5294

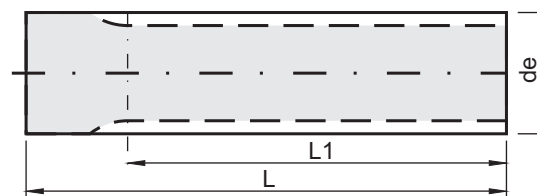
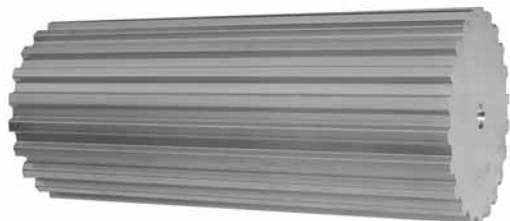

MXL

podziałka: **0,80" (2,032 mm)**
materiał: **aluminium**

XL

podziałka: **1/5" (5,08 mm)**
materiał: **aluminium**

| kod | typ | Z | de | L1 | L | [kg] |
|-------|-----|----|-------|-----|-----|------|
| H0213 | MXL | 12 | 7,25 | 50 | 75 | 0,01 |
| H0214 | MXL | 14 | 8,55 | 50 | 75 | 0,01 |
| H0215 | MXL | 15 | 9,19 | 50 | 75 | 0,01 |
| H0216 | MXL | 16 | 9,84 | 50 | 75 | 0,02 |
| H0217 | MXL | 18 | 11,13 | 50 | 75 | 0,02 |
| H0218 | MXL | 20 | 12,43 | 90 | 120 | 0,04 |
| H0219 | MXL | 22 | 13,72 | 125 | 140 | 0,05 |
| H0220 | MXL | 24 | 15,02 | 125 | 140 | 0,06 |
| H0221 | MXL | 25 | 15,66 | 125 | 140 | 0,07 |
| H0222 | MXL | 26 | 16,31 | 125 | 140 | 0,08 |
| H0223 | MXL | 28 | 17,60 | 125 | 140 | 0,09 |
| H0224 | MXL | 30 | 18,90 | 125 | 140 | 0,10 |
| H0225 | MXL | 32 | 20,19 | 125 | 140 | 0,12 |
| H0226 | MXL | 34 | 21,48 | 125 | 140 | 0,13 |
| H0227 | MXL | 36 | 22,78 | 140 | 140 | 0,15 |
| H0228 | MXL | 38 | 24,07 | 140 | 140 | 0,17 |
| H0229 | MXL | 40 | 25,36 | 140 | 140 | 0,19 |
| H0230 | MXL | 42 | 26,66 | 140 | 140 | 0,20 |
| H0231 | MXL | 44 | 27,95 | 140 | 140 | 0,23 |
| H0232 | MXL | 45 | 28,60 | 140 | 140 | 0,24 |
| H0233 | MXL | 48 | 30,54 | 140 | 140 | 0,27 |
| H0234 | MXL | 50 | 31,83 | 140 | 140 | 0,30 |
| H0235 | MXL | 60 | 38,30 | 160 | 160 | 0,49 |
| H0236 | MXL | 70 | 44,77 | 160 | 160 | 0,67 |
| H0237 | MXL | 72 | 46,06 | 160 | 160 | 0,72 |

| kod | typ | Z | de | L1 | L | [kg] |
|-------|-----|----|--------|-----|-----|------|
| H0238 | XL | 10 | 15,66 | 140 | 140 | 0,07 |
| H0239 | XL | 11 | 17,28 | 140 | 140 | 0,08 |
| H0240 | XL | 12 | 18,90 | 140 | 140 | 0,10 |
| H0241 | XL | 13 | 20,51 | 140 | 140 | 0,11 |
| H0242 | XL | 14 | 22,13 | 140 | 140 | 0,13 |
| H0243 | XL | 15 | 23,75 | 140 | 140 | 0,16 |
| H0244 | XL | 16 | 25,36 | 140 | 140 | 0,18 |
| H0245 | XL | 17 | 26,98 | 140 | 140 | 0,20 |
| H0246 | XL | 18 | 28,60 | 140 | 140 | 0,23 |
| H0247 | XL | 19 | 30,22 | 140 | 140 | 0,26 |
| H0248 | XL | 20 | 31,83 | 140 | 140 | 0,28 |
| H0249 | XL | 21 | 33,45 | 160 | 160 | 0,36 |
| H0250 | XL | 22 | 35,07 | 160 | 160 | 0,40 |
| H0251 | XL | 23 | 36,60 | 160 | 160 | 0,44 |
| H0252 | XL | 24 | 38,30 | 160 | 160 | 0,48 |
| H0253 | XL | 25 | 39,92 | 160 | 160 | 0,51 |
| H0254 | XL | 26 | 41,53 | 160 | 160 | 0,56 |
| H0255 | XL | 27 | 43,15 | 160 | 160 | 0,60 |
| H0256 | XL | 28 | 44,77 | 160 | 160 | 0,65 |
| H0257 | XL | 29 | 46,39 | 160 | 160 | 0,70 |
| H0258 | XL | 30 | 48,00 | 160 | 160 | 0,75 |
| H0259 | XL | 32 | 51,24 | 160 | 160 | 0,87 |
| H0260 | XL | 33 | 52,85 | 160 | 160 | 0,92 |
| H0261 | XL | 34 | 54,47 | 160 | 160 | 0,98 |
| H0262 | XL | 35 | 56,09 | 160 | 160 | 1,04 |
| H0263 | XL | 36 | 57,70 | 160 | 160 | 1,10 |
| H0264 | XL | 38 | 60,94 | 160 | 160 | 1,23 |
| H0265 | XL | 39 | 62,56 | 160 | 160 | 1,30 |
| H0266 | XL | 40 | 64,17 | 160 | 160 | 1,37 |
| H0267 | XL | 41 | 65,79 | 160 | 160 | 1,43 |
| H0268 | XL | 42 | 67,41 | 160 | 160 | 1,51 |
| H0269 | XL | 43 | 69,02 | 160 | 160 | 1,58 |
| H0270 | XL | 44 | 70,64 | 160 | 160 | 1,65 |
| H0271 | XL | 48 | 77,11 | 160 | 160 | 1,98 |
| H0272 | XL | 56 | 90,04 | 160 | 160 | 2,71 |
| H0273 | XL | 60 | 96,51 | 160 | 160 | 3,10 |
| H0274 | XL | 72 | 115,92 | 160 | 160 | 4,52 |

WAŁKI ZĘBATE O PODZIAŁCE CALOWEJ

ISO 5294

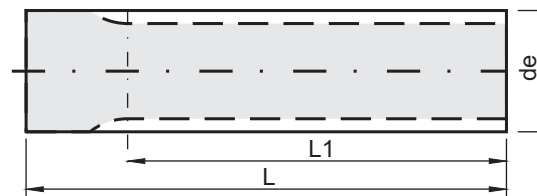
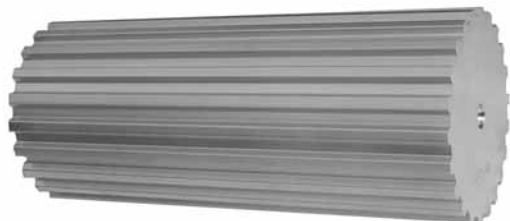

L podziałka: **3/8" (9,525 mm)**
materiał: **aluminium**

L podziałka: **3/8" (9,525 mm)**
materiał: **stal**

| kod | typ | Z | de | L1 | L | [kg] |
|-------|-----|----|-------|-----|-----|------|
| H0275 | L | 10 | 29,56 | 140 | 140 | 0,23 |
| H0276 | L | 11 | 32,59 | 140 | 140 | 0,28 |
| H0277 | L | 12 | 35,62 | 160 | 160 | 0,39 |
| H0278 | L | 13 | 38,65 | 160 | 160 | 0,46 |
| H0279 | L | 14 | 41,68 | 160 | 160 | 0,55 |
| H0280 | L | 15 | 44,72 | 160 | 160 | 0,63 |
| H0281 | L | 16 | 47,75 | 160 | 160 | 0,73 |
| H0282 | L | 17 | 50,78 | 160 | 160 | 0,82 |
| H0283 | L | 18 | 53,81 | 160 | 160 | 0,93 |
| H0284 | L | 19 | 56,84 | 160 | 160 | 1,04 |
| H0285 | L | 20 | 59,88 | 160 | 160 | 1,16 |
| H0286 | L | 21 | 62,91 | 160 | 160 | 1,28 |
| H0287 | L | 22 | 65,94 | 160 | 160 | 1,41 |
| H0288 | L | 23 | 68,97 | 160 | 160 | 1,55 |
| H0289 | L | 24 | 72,00 | 160 | 160 | 1,69 |
| H0290 | L | 27 | 81,10 | 160 | 160 | 2,15 |
| H0291 | L | 30 | 90,20 | 160 | 160 | 2,67 |

| kod | typ | Z | de | L1 | L | [kg] |
|-------|-----|----|-------|-----|-----|------|
| H0292 | L | 10 | 29,56 | 140 | 140 | 0,66 |
| H0293 | L | 11 | 32,59 | 140 | 140 | 0,81 |
| H0294 | L | 12 | 35,62 | 160 | 160 | 1,12 |
| H0295 | L | 13 | 38,65 | 160 | 160 | 1,32 |
| H0296 | L | 14 | 41,68 | 160 | 160 | 1,57 |
| H0297 | L | 15 | 44,72 | 160 | 160 | 1,81 |
| H0298 | L | 16 | 47,75 | 160 | 160 | 2,08 |
| H0299 | L | 17 | 50,78 | 160 | 160 | 2,34 |
| H0300 | L | 18 | 53,81 | 160 | 160 | 2,64 |
| H0301 | L | 19 | 56,84 | 160 | 160 | 2,96 |
| H0302 | L | 20 | 59,88 | 160 | 160 | 3,32 |
| H0303 | L | 21 | 62,91 | 160 | 160 | 3,67 |
| H0304 | L | 22 | 65,94 | 160 | 160 | 4,07 |
| H0305 | L | 23 | 68,97 | 160 | 160 | 4,44 |
| H0306 | L | 24 | 72,00 | 160 | 160 | 4,86 |
| H0307 | L | 27 | 81,10 | 160 | 160 | 6,20 |
| H0308 | L | 30 | 90,20 | 160 | 160 | 7,72 |