

# WAŁKI ZĘBATE O PODZIAŁCE METRYCZNEJ

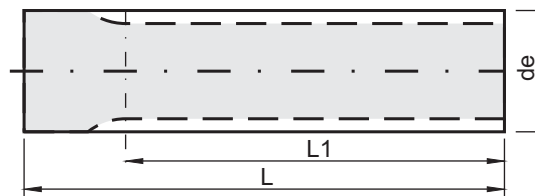
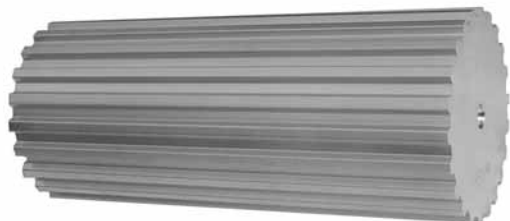

## HTD 5M

podziałka: **5 mm**  
materiał: **aluminium**

| kod   | typ | Z  | de     | L1  | L   | [kg] |
|-------|-----|----|--------|-----|-----|------|
| H0164 | 5M  | 12 | 17,96  | 160 | 160 | 0,08 |
| H0165 | 5M  | 13 | 19,55  | 160 | 160 | 0,10 |
| H0166 | 5M  | 14 | 21,14  | 175 | 200 | 0,16 |
| H0167 | 5M  | 15 | 22,73  | 175 | 200 | 0,19 |
| H0168 | 5M  | 16 | 24,32  | 175 | 200 | 0,21 |
| H0169 | 5M  | 17 | 25,92  | 175 | 200 | 0,24 |
| H0170 | 5M  | 18 | 27,51  | 200 | 200 | 0,27 |
| H0171 | 5M  | 19 | 29,10  | 200 | 200 | 0,31 |
| H0172 | 5M  | 20 | 30,69  | 200 | 200 | 0,35 |
| H0173 | 5M  | 21 | 32,28  | 200 | 200 | 0,39 |
| H0174 | 5M  | 22 | 33,87  | 200 | 200 | 0,43 |
| H0175 | 5M  | 23 | 35,47  | 200 | 200 | 0,48 |
| H0176 | 5M  | 24 | 37,06  | 200 | 200 | 0,52 |
| H0177 | 5M  | 25 | 38,65  | 200 | 200 | 0,57 |
| H0178 | 5M  | 26 | 40,24  | 200 | 200 | 0,62 |
| H0179 | 5M  | 27 | 41,83  | 200 | 200 | 0,67 |
| H0180 | 5M  | 28 | 43,42  | 200 | 200 | 0,73 |
| H0181 | 5M  | 30 | 46,61  | 200 | 200 | 0,84 |
| H0182 | 5M  | 32 | 49,79  | 200 | 200 | 0,97 |
| H0183 | 5M  | 34 | 52,97  | 200 | 200 | 1,11 |
| H0184 | 5M  | 36 | 56,16  | 200 | 200 | 1,25 |
| H0185 | 5M  | 38 | 59,34  | 200 | 200 | 1,40 |
| H0186 | 5M  | 40 | 62,52  | 200 | 200 | 1,55 |
| H0187 | 5M  | 42 | 65,71  | 200 | 200 | 1,73 |
| H0188 | 5M  | 44 | 68,89  | 200 | 200 | 1,90 |
| H0189 | 5M  | 45 | 70,48  | 200 | 200 | 1,99 |
| H0190 | 5M  | 48 | 75,25  | 200 | 200 | 2,27 |
| H0191 | 5M  | 50 | 78,44  | 200 | 200 | 2,48 |
| H0192 | 5M  | 60 | 94,35  | 200 | 200 | 3,60 |
| H0193 | 5M  | 72 | 113,45 | 200 | 200 | 5,28 |

## HTD 8M

podziałka: **8 mm**  
materiał: **stal**

| kod   | typ | Z  | de     | L1  | L   | [kg]  |
|-------|-----|----|--------|-----|-----|-------|
| H0194 | 8M  | 18 | 44,47  | 200 | 200 | 2,03  |
| H0195 | 8M  | 19 | 47,01  | 200 | 200 | 2,30  |
| H0196 | 8M  | 20 | 49,56  | 200 | 200 | 2,57  |
| H0197 | 8M  | 21 | 52,11  | 200 | 200 | 2,88  |
| H0198 | 8M  | 22 | 54,65  | 200 | 200 | 3,18  |
| H0199 | 8M  | 23 | 57,20  | 200 | 200 | 3,52  |
| H0200 | 8M  | 24 | 59,75  | 200 | 200 | 3,86  |
| H0201 | 8M  | 25 | 62,29  | 200 | 200 | 4,23  |
| H0202 | 8M  | 26 | 64,84  | 200 | 200 | 4,60  |
| H0203 | 8M  | 28 | 69,93  | 200 | 200 | 5,40  |
| H0204 | 8M  | 30 | 75,02  | 200 | 200 | 6,27  |
| H0205 | 8M  | 32 | 80,12  | 200 | 200 | 7,20  |
| H0206 | 8M  | 34 | 85,21  | 200 | 200 | 8,20  |
| H0207 | 8M  | 35 | 87,76  | 200 | 200 | 8,71  |
| H0208 | 8M  | 36 | 90,30  | 200 | 200 | 9,26  |
| H0209 | 8M  | 38 | 95,40  | 200 | 200 | 10,39 |
| H0210 | 8M  | 40 | 100,49 | 200 | 200 | 11,58 |
| H0211 | 8M  | 44 | 110,68 | 200 | 200 | 14,16 |
| H0212 | 8M  | 48 | 120,86 | 200 | 200 | 16,99 |