

# EK6

## WITH CONICAL CLAMPING RING

1,950 - 25,000 Nm



### ABOUT

#### FEATURES

- ▶ high clamping pressure
- ▶ self centering on shaft
- ▶ very high concentricity

#### MATERIAL

- ▶ **Hubs:** GGG40
- ▶ **Elastomer:** wear resistant thermally stable TPU

#### DESIGN

Two concentrically machined hubs with curved jaws and conical clamping rings. 5x elastomer segments press fit for zero backlash; standard versions are electrically isolating.

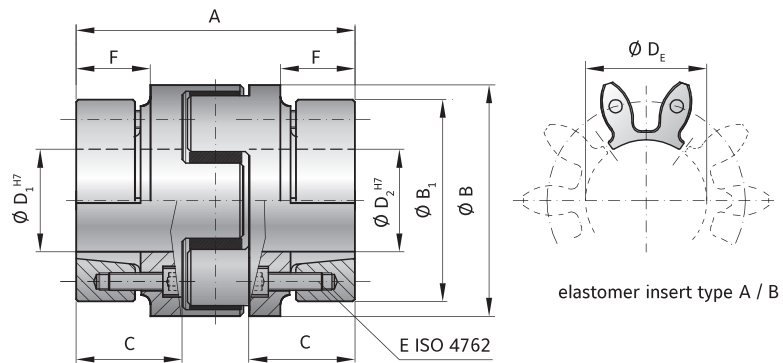

## MODEL EK6

SIZE		2500		4500		9500	
Type (Elastomer insert)		A	B	A	B	A	B
Rated torque (Nm)	$T_{KN}$	1950	2450	5000	6200	10000	12500
Max. torque (Nm)	$T_{Kmax}$	3900	4900	10000	12400	20000	25000
Overall length (mm)	A	177		227		282	
Outside diameter (mm)	B/B <sub>1</sub>	160 / 159		225 / 208		285	
Mounting length (mm)	C	70		90		112	
Inside diameter range H7 (mm)	D <sub>1/2</sub>	40 - 95		50 - 130		60 - 170	
Inside diameter of elastomer (mm)	D <sub>E</sub>	80		111		145	
Clamping screw (ISO 4762)		10x M10		10x M12		10x M16	
Tightening torque of the clamping screw (Nm)	E	60		100		160	
Distance (mm)	F	51		66		80	
Moment of inertia per hub (10 <sup>-3</sup> kgm <sup>2</sup> )	J <sub>1</sub> /J <sub>2</sub>	31.7		135.7		469.2	
Approx. weight (kg)		15		35		73	
Speed standard (min <sup>-1</sup> )		3,500		3,000		2,000	
Speed balanced (10 <sup>3</sup> min <sup>-1</sup> )		10	10	8	8	6.5	6.5

For information on shaft misalignment, torsional stiffness, and other details about the elastomer inserts see pages 66 + 67.

ORDERING EXAMPLE	EK6	2500	A	50.8	80	XX
Model	●					Special designation only (e.g. special bore tolerance).
Size		●				
Elastomer insert type			●			
Bore D1 H7				●		
Bore D2 H7					●	
For custom features place an XX at the end of the part number and describe the special requirements (e.g. EK6 / 2500 / A / 50.8 / 80 / XX; XX=stainless steel)						